

ESP-B系列 ESP-B Series

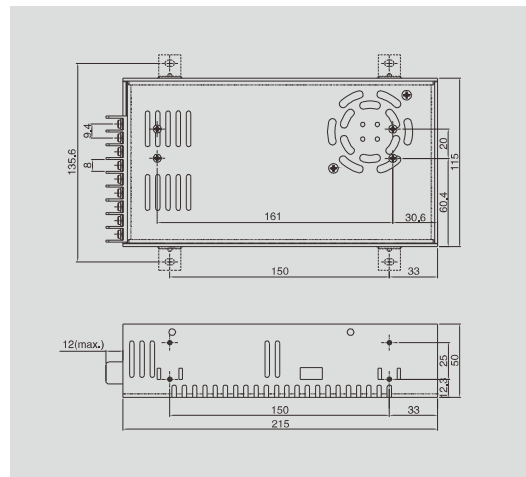

产品特性

AC输入
过压 / 过流 / 过温保护
内置风扇冷却
适用于LED显示、工业控制
2年质保

Product features

AC input
Protections: Over voltage / Over-current / Over temperature
Forced air cooling by built-in fan
LED indicator for power on
2 years warranty

技术特性

输入电压 90~132Vac, 180~264Vac, 手动开关转换
输入频率 47~63Hz
冲击电流 <50A 满载冷态
保持时间 ≥20ms@230Vac 满载
过载保护 120%~150% 限流保护, 自动恢复
过压保护 115%~145% Vo
运行温度 -20℃~70℃
安全标准 EN60950-1
EMC标准 EN61000-6-2 EN61000-4-2,3,4,5,6,8,11 EN55022 Class B
绝缘标准 I/P-O/P: 1.5kVac, 1min I/P-FG: 1.5kVac, 1min O/P-FG: 0.5kVac, 1min
重量 0.92kg/pcs

Specifications

Input voltage 90~132Vac, 180~264Vac, selectable by switch
Input frequency 47~63Hz
Inrush current <50A full load cold start
Hold up time ≥20ms@230Vac full load
Overload protection 120%~150% constant current limit, auto-recovery
Over voltage protection 115%~145% Vo
Operating temperature -20℃~70℃
Safety standard EN60950-1
EMC standard EN61000-6-2 EN61000-4-2,3,4,5,6,8,11 EN55022 Class B
Withstand voltage I/P-O/P: 1.5kVac, 1min I/P-FG: 1.5kVac, 1min O/P-FG: 0.5kVac, 1min
Weight 0.92kg/pcs

| P/N 产品型号 | Output 输出 | R & N 纹波 & 噪声 | Effi. 效率 | Load Regulation 负载调整率 | DC adjustment range DC可调范围 |
|-------------|------------|---------------|----------|-----------------------|----------------------------|
| ESP-350B-5 | 5V, 50A | 100mV | 80% | ±2% | 4.5V~5.5V |
| ESP-350B-12 | 12V, 29A | 100mV | 80% | ±2% | 10.8V~13.2V |
| ESP-350B-24 | 24V, 14.6A | 100mV | 83% | ±2% | 21.6V~26.4V |
| ESP-350B-36 | 36V, 9.7A | 240mV | 84% | ±2% | 32.4V~39.6V |
| ESP-350B-48 | 48V, 7.3A | 240mV | 85% | ±2% | 43.2V~52.8V |

平板开关电源 MOUNTED POWER SUPPLY